

EXPLODED VIEW, PARTS AND PRICE LIST  
Models .177 Cal. 38T and C

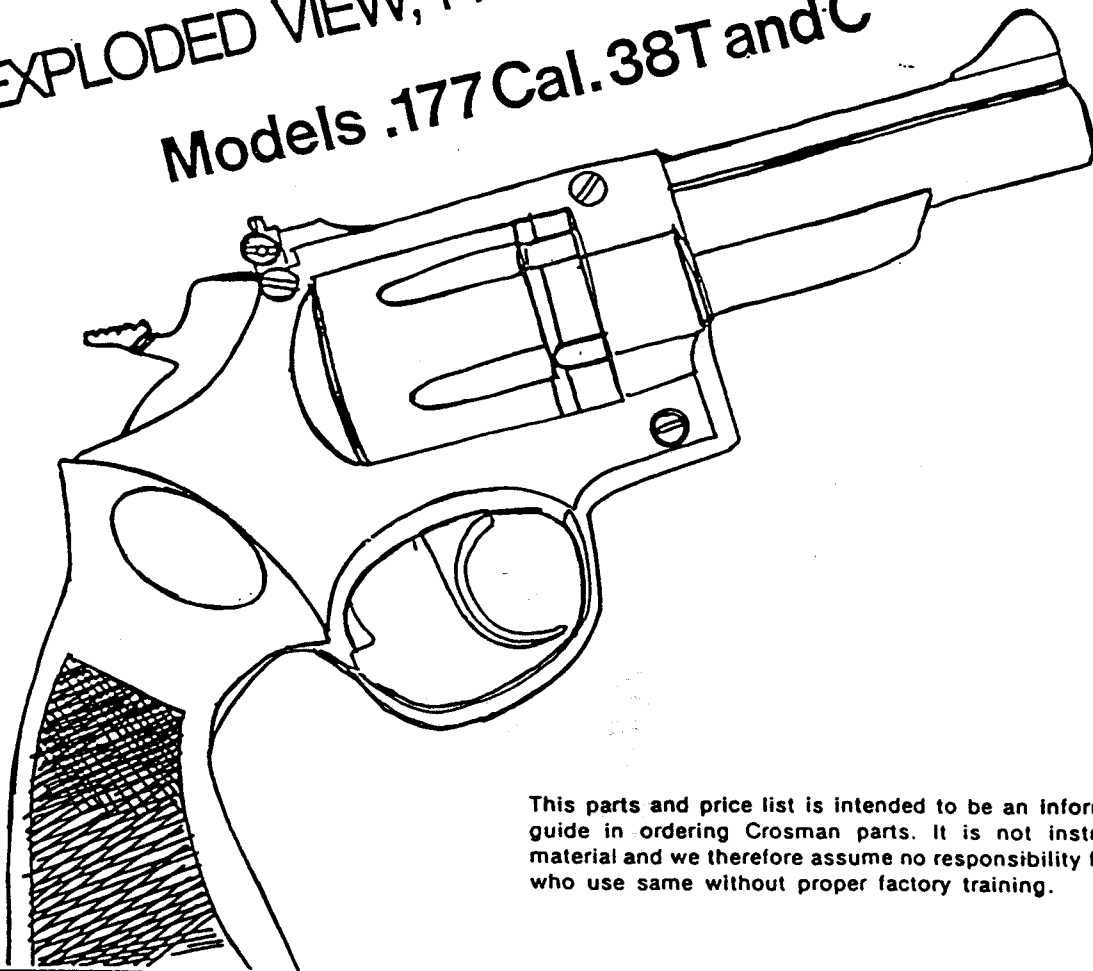

This parts and price list is intended to be an informational guide in ordering Crosman parts. It is not instructional material and we therefore assume no responsibility for those who use same without proper factory training.

Figure I

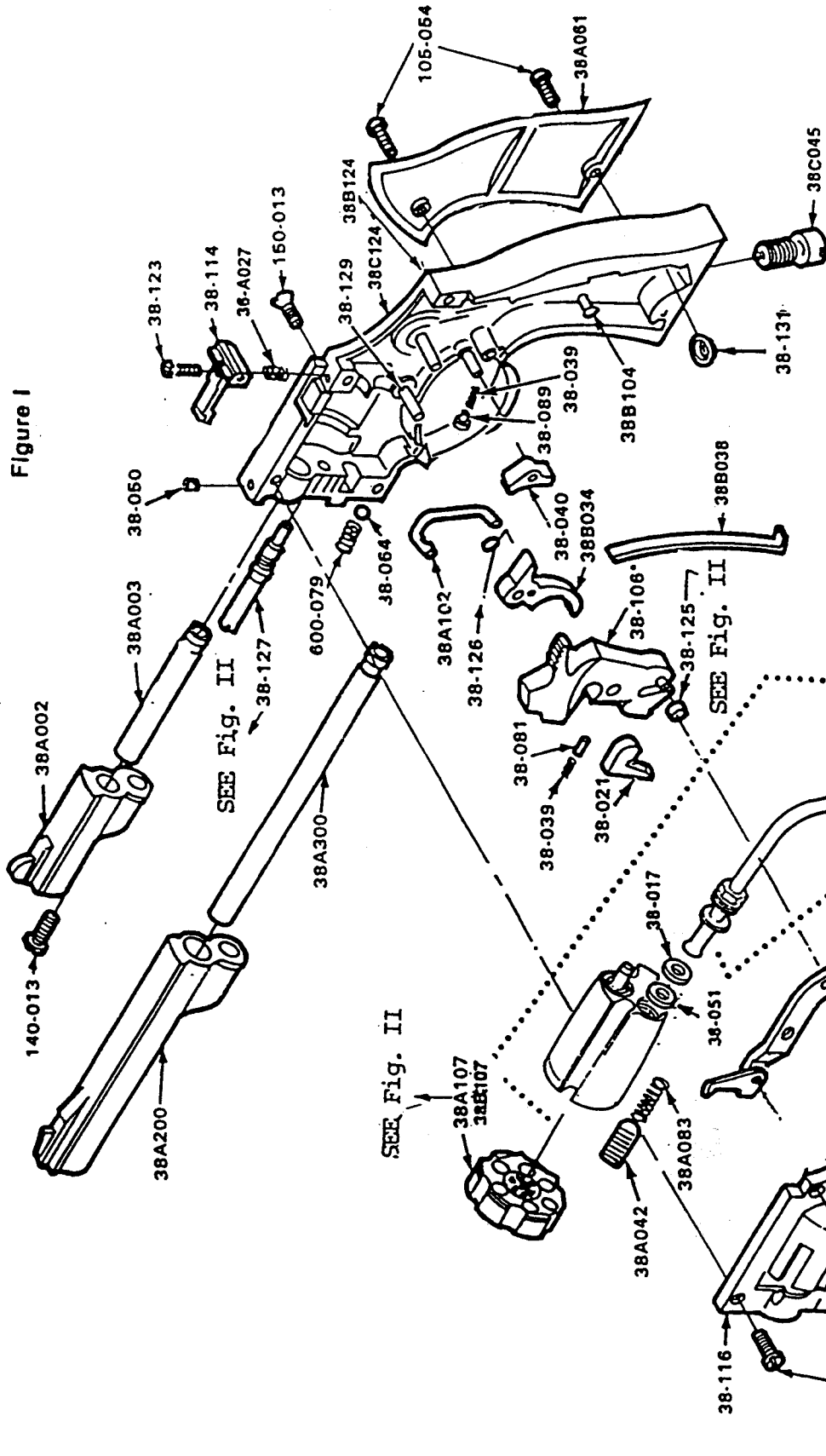
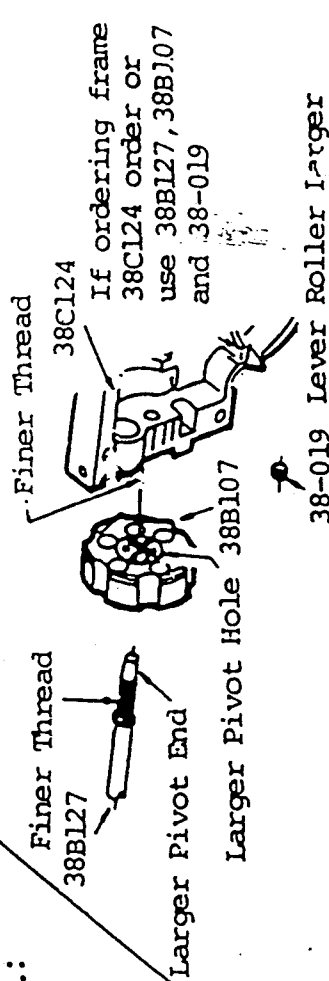

Figure II

Gun Manufactured after Jan. '81  
Serial # 281

See back page for breakdown



Factory Assembly Only

38-019 Lever Roller Larger

If ordering frame  
38C124 order or  
use 38B127, 38B107  
and 38-019

# .177 Cal.

## ASSEMBLY PROCEDURES

### Valve Assembly

1. Place "O" Ring 38-130 into Valve Body 38A009. Valve Washer 38-095 is then placed in Valve Body 38B009 flat side down.
2. Place Spacer 38-022 in Valve Body 38B009 and press around edge with screwdriver to properly seat "O" Ring 38-130.
3. Valve Spring 38B078 is then placed in Valve Body 38B009. Wide end first.
4. Lubricate Valve Stem 38A018 w/Pell Gun Oil.
5. Place Valve Seal 38-094, Lubricate "O" Ring 140-058 and Valve Seat 38-091 on Valve Stem 38A018. Insert entire unit into Valve Body 38B009 with thumb and forefinger holding all parts firmly against Valve Seat 38-091. Continue to apply pressure on Valve Seat 38-091 and place Valve Seat Wrench T-38-11 over end of Valve Stem 38A018 to tighten seat. NOTE: Tighten until finger tight only.

### Piercing Assembly

1. Place Washer 38-051 into Valve Body 38B009.
2. Assemble Gland Gasket 38-017 and Tube Seal 38-065. Lubricate area around Gland Gasket 38-017 and place in Valve Body 38B009.
3. Place Piercing Screen 38-028, Piercing Pin 38A027 into Piercing Block 38-026. Lubricate End Seal 38-128 before inserting in Piercing Block. Place Guide Collar 500-064 over End Seal 38-128. Guide Collar 500-064 should be turned down until snug. Beyond this point the center of End Seal 38-128 will be forced open, causing a leak. Now place entire Piercing Assembly 38-056 onto Tube Assembly 38-056. NOTE: Lubricate Tube Seal 38-065 before putting Piercing Assembly 38-056 and Tube Assembly 38-056 together.

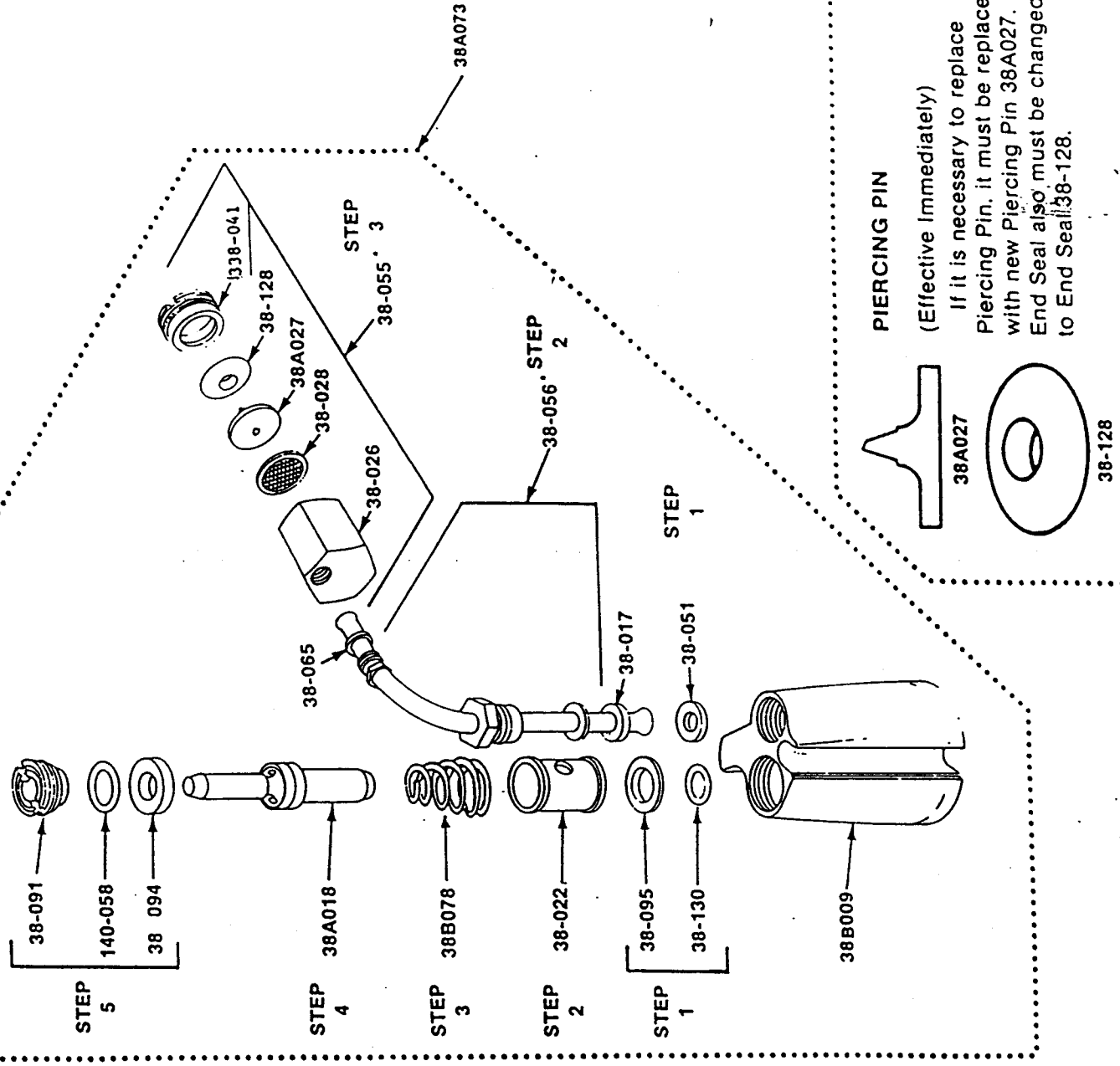

MODELS 38C & T (.177 Cal.) ASSEMBLIES D PARTS LIST

PRICE

PART NO.	QTY.	DESCRIPTION	PRICE	PART NO.	QTY.	DESCRIPTION	PRICE
38A002	1	Barrel Housing(Short)		38-089	1	Guide	
38A003	1	Barrel (Short)		38-091	1	Valve Seat	
38B009	1	Valve Body		38-094	1	Valve Seal	
38-017	1	Gland Gasket		38-095	1	Valve Washer	
38A018	1	Valve Stem		38A102	1	Safety Link	
38-019	1	Roller(Use with 38C124 Frame)		38B104	1	Spring Pivot	
38-021	1	Hammer Pawl		38-106*	1	Hammer Assembly	
38-022	1	Spacer		38A107	1	Cylinder (Use with 38B124 Fram	
38-026	1	Piercing Block		38B107	1	Cylinder(Use with 38C124 Fram	
38A027	1	Piercing Pin		38-114*	1	Rear Sight Assembly	
38-028	1	Piercing Screen		38-116	1	Cover Sold only as Assembly	
38B034	1	Trigger		38-117	5	Frame Screw	
38B038	1	Hammer Spring		38-123	1	Elevation Screw	
38-039	2	Sear Spring		38B124	1	Frame Assembly	
38-040	1	Sear		38C124	1	Frame Assembly	
38A042	1	Loader		38-125	1	Roller	
38C045	1	Powerlet Screw		38-126	1	Trigger Spring	
38-050	1	Barrel Screw		38-127	1	Shaft (Use with 38B124 Frame	
38-051	1	Washer		38B127	1	Shaft(Use with 38C124 Frame)	
38A054*	1	Lever Assembly		38-128	1	End Seal	
38-055*	1	Piercing Assembly		38-129	1	Trigger Pin	
38-056*	1	Tube Assembly		38-130	1	O'Ring	
38A061	1	Grip,R.H.		38-131	1	Screw Tip	
38-064	1	Ball		38A200	1	Barrel Housing-Long	
38-065	1	Tube Seal		38A300	1	Barrel - Long	
38A071	1	L.H. Grip Assembly		36A027	1	Elevation Spring	
38A073	1	Valve & Piercing Assembly		105-054	2	Grip Screw	
38B078	1	Valve Spring		140-013	1	Screw	
38A079	1	Pell Removal Rod		140-058	1	No. 6 O-Ring	
38-081	1	Guide Pin		150-013	1	Screw	
38A083	1	Loader Spring		338-041	1	Guide Collar	
				500-064	1	Guide Collar Repaced by 338-041	
				600-079	1	Decent Spring	

without notice. Check or money order in amount of total purchase must accompany parts order.  
 Order by part number and description. Prices subject to change

TO BE USED AS REFERENCE GUIDE ONLY